

TRECHO A - 76M

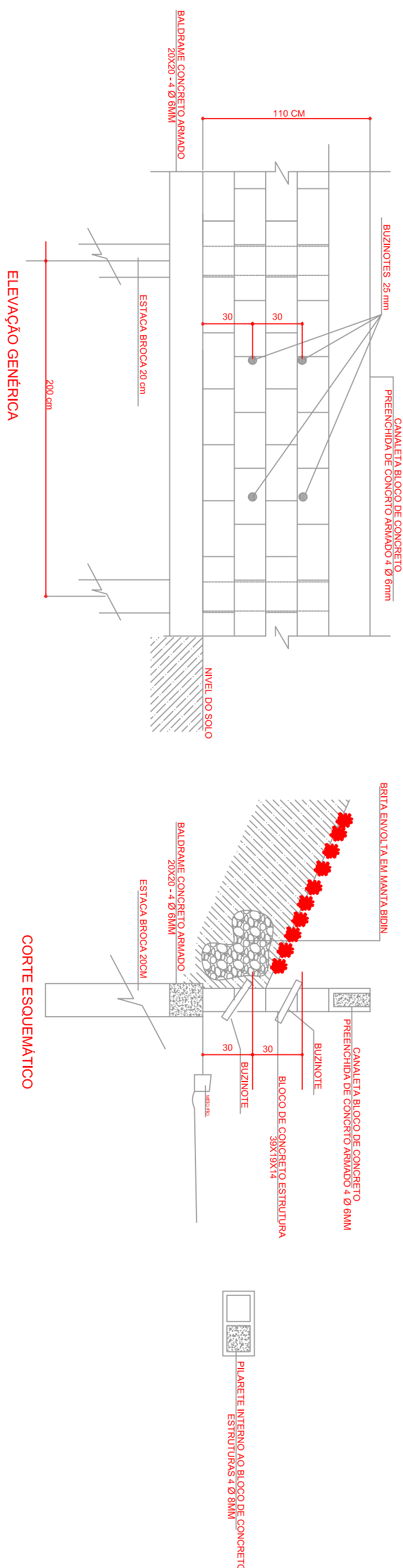

TRECHO A - 76M

## DETALHE MURO ARRIMO

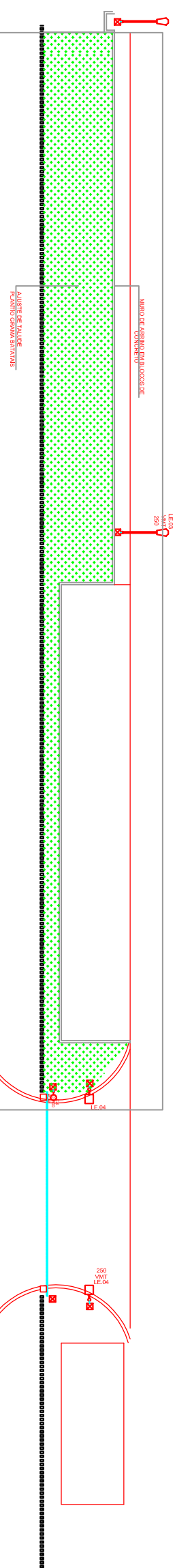

TRECHO B - 55M

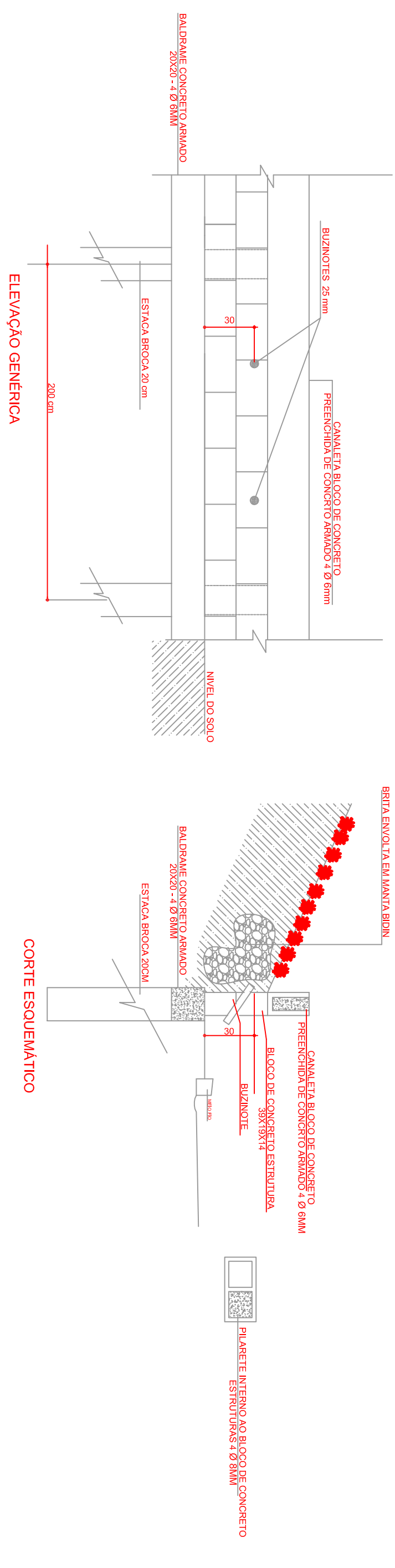

TRECHO B - 55M

## DETALHE MURO ARRIMO

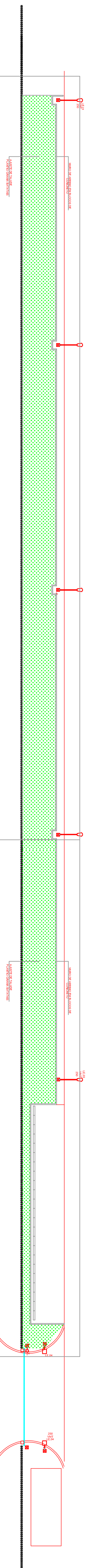

TRECHO A - 76M

TRECHO B - 55M

VISÃO GERAL DAS INTERVENÇÕES NOS TRECHOS "A" E "B"

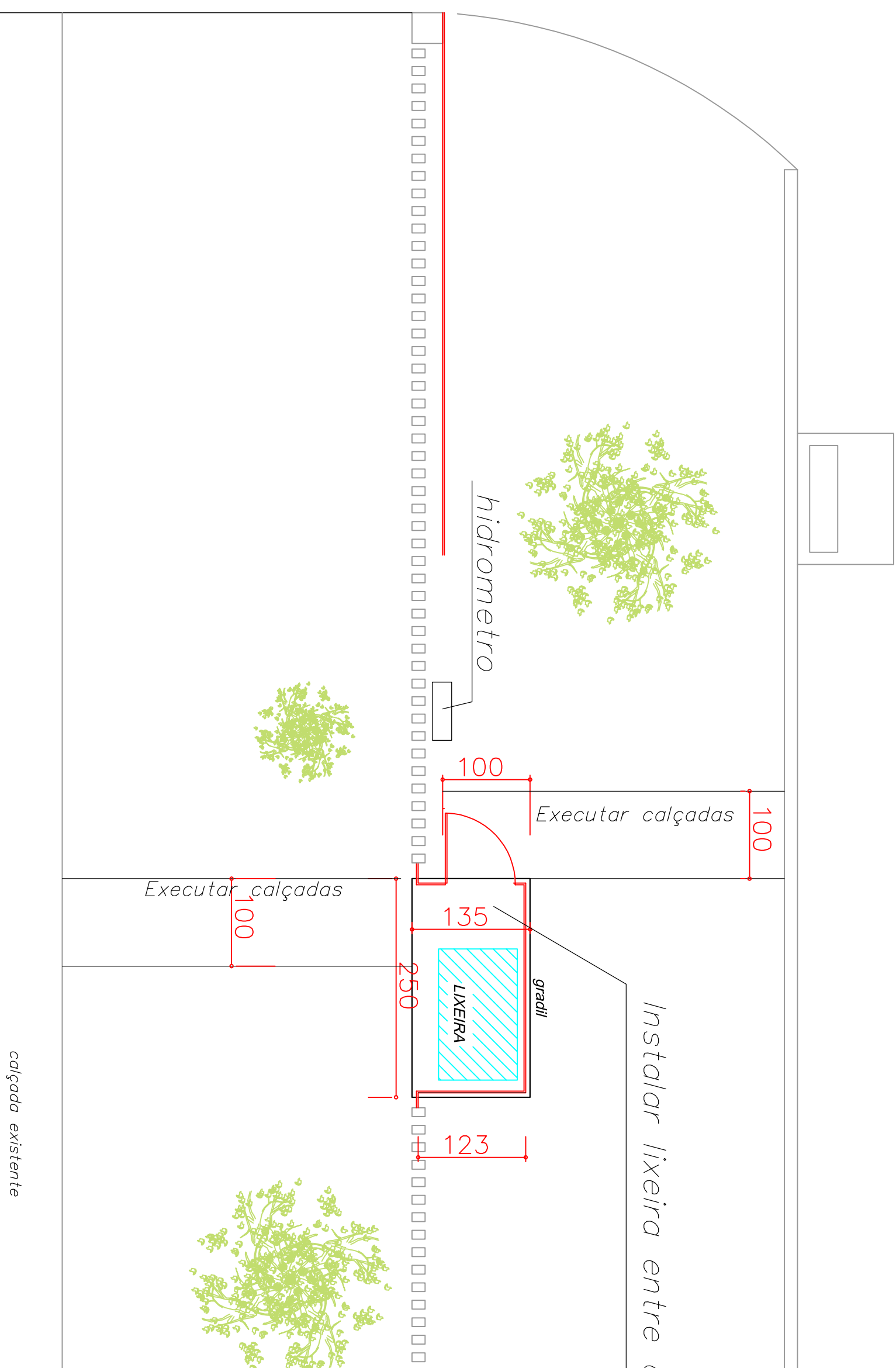

## INSTALAÇÃO DE LIXEIRA

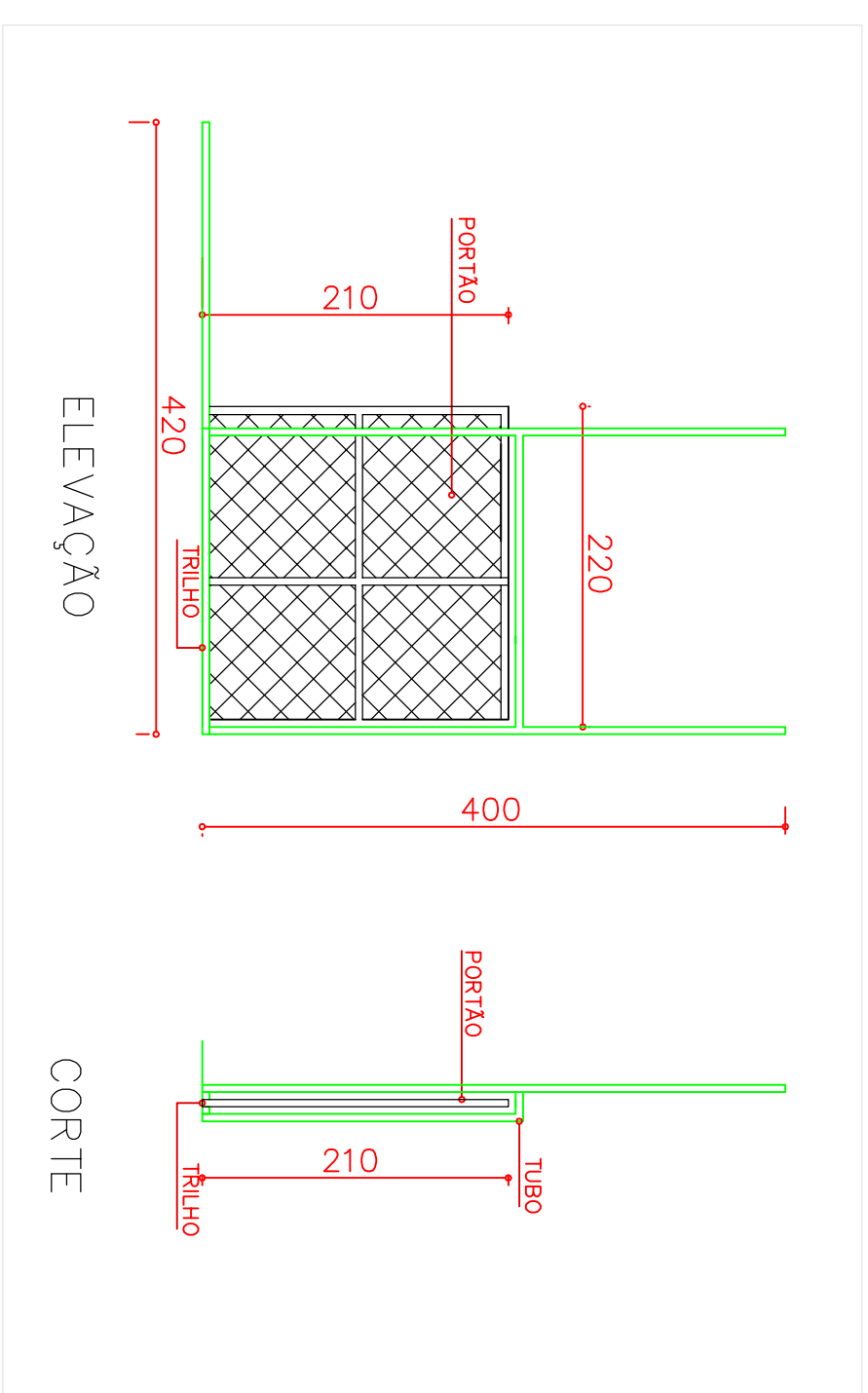

## INSTALAÇÃO DE PORTÃO